

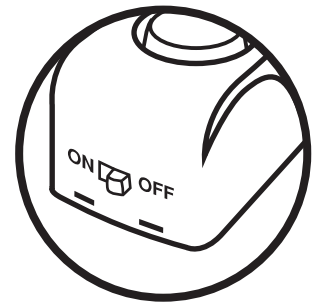

door stop alarm

instruction sheet

Please keep these instructions in a safe place for future reference



Contents:

- 1 x Door Stop
- 1 x 9V battery

There is no assembly required.

Battery installation:

No tools are required. When you are ready to use the Door Stop, toggle the ON/OFF switch to OFF. Turn the Door Stop over and remove the battery compartment cover.

Insert the 9V battery by inserting the back of the battery first and then pushing on the end with the prongs, following the diagram in the battery compartment.

Replace the battery compartment cover.

To test to make sure the battery is installed correctly, toggle the ON/OFF switch to ON, then firmly tap down and then release the metal cover on the Door Stop. The siren is loud so you may place your hand over the alarm to soften the sound. Once the alarm sounds you may stop it by toggling the ON/OFF switch to OFF. The Door Stop is ready to use.

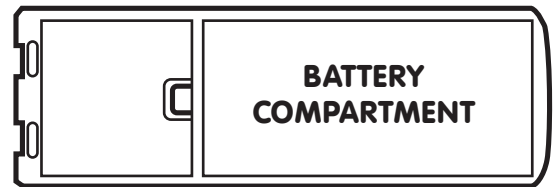
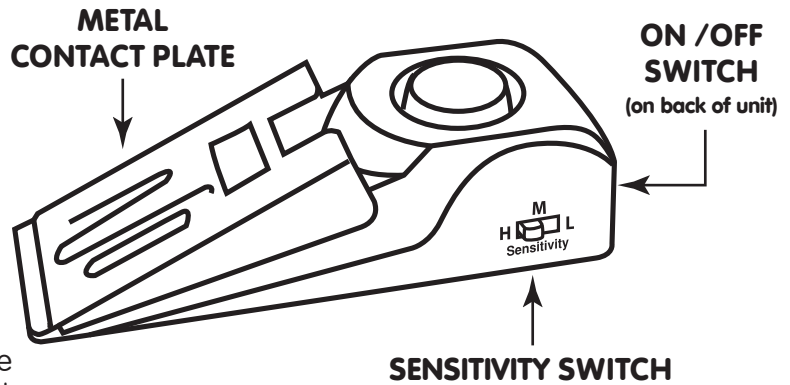

(BOTTOM VIEW)

Operation:

Toggle the ON/OFF switch to ON.

When the door is closed, place the Door Stop under the door gap as shown in the drawing. Do not push it under the door too far or the metal plate will depress and the alarm will sound.

Make sure the non-skid pads on the bottom of the unit are in firm contact with the floor.

When not in use, toggle the ON/OFF switch to OFF.

The Door Stop also has a movement sensor with a sensitivity switch that alerts you if someone tries to impact or shock the alarm.

You may choose between high (H), medium (M), or low (L) sensitivity.

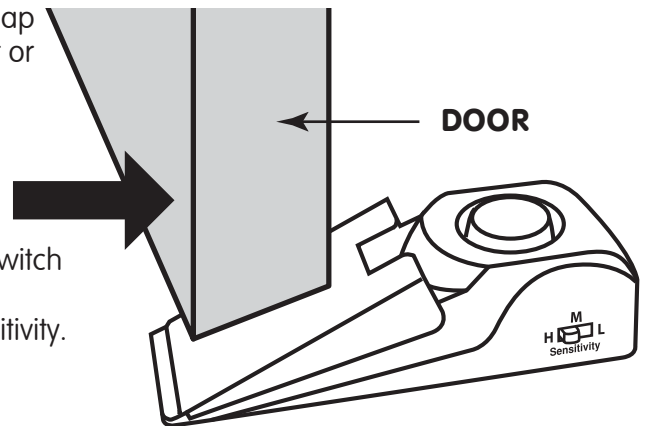

Important:

Replace fully discharged batteries immediately.

When storing the Door Stop for an extended length of time, or while traveling,

remove the battery. Batteries corrode over time and may cause damage to the Door Stop.

Replace fully discharged batteries immediately.

Caution:

- **Batteries may leak harmful liquids or ignitable materials or explode causing injury and product damage.**
- Do not mix old and new batteries or other battery types
- Replace all batteries of the same kind at the same time
- Replace fully discharged batteries immediately

Note:

This product is designed to be a deterrent. It is an alarm signal. It does not guarantee protection.

