



BELLY GLO

Portable Night Light

INSTRUCTIONS

PORTABLE NIGHT LIGHT OPERATION

Thank you for purchasing a Lullabies Belly Glo Portable Night Light. Each unit has been manufactured to ensure safety and reliability.

Before using for the first time, please read the instructions carefully and keep them for further reference.

To Charge:

1. Plug the Belly Bulb (Night Light) into a 120V outlet to charge the light.
2. Fully charge the Night Light (5-6 hours) before first use.
3. The Belly Bulb (Night Light) can stay in the outlet as a wall night light or can be placed inside the Belly Glo animal.

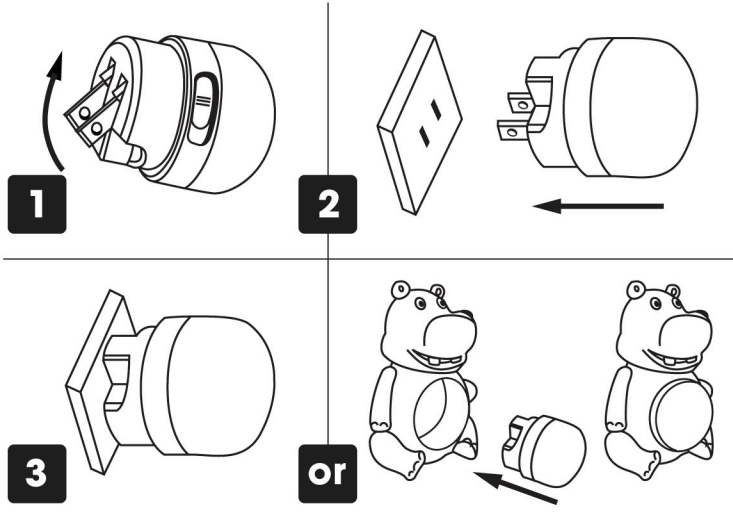

CONTROLS

Automatic On/Off Sensor

On the control switch side of the Belly Bulb (Night Light), select **WHITE** or **COLOR** to activate the Night Light.

NOTE: The Night Light illuminates only in the dark.

1. Slide the switch to the **RIGHT** side (**COLOR**) to activate the three color light cycle.
2. Slide the switch to the **LEFT** side (**WHITE**) to activate the white color light.
3. Slide the switch to **OFF** (**OFF**) to power off the Night Light.

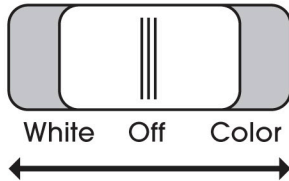

SAFETY PRECAUTIONS

⚠ WARNING

RISK OF ELECTRICAL SHOCK

- THIS PRODUCT IS NOT A TOY
- NOT INTENDED FOR USE BY CHILDREN
- FOR ADULT USE ONLY
- DO NOT USE WITH EXTENSION CORDS
- USE INDOORS ONLY

RISK OF FIRE

- PLUG ONLY IN EXPOSED WALL OUTLETS WHERE NIGHT LIGHT IS VENTILATED AND CANNOT CONTACT BED COVERINGS OR OTHER MATERIAL THAT MIGHT PRESENT A FIRE HAZARD.

CAUTION!

THE NIGHT LIGHT IS NOT WATERPROOF. DO NOT IMMERSE IN WATER.

TECHNICAL SPECIFICATIONS

| | |
|---------------------|------------------------------------|
| Rating Voltage | 120V |
| Frequency | 60Hz |
| Charging Cycle Life | 500 Charges |
| Light | White: LED 0.05W, Color: LED 0.10W |
| Charging Time | Approx. 5-6 hours |
| Operation Time | Approx. 8-10 hours |

AFTER SALES SUPPORT

📞 [1-888-367-7373](tel:1-888-367-7373)
 📧 customer-service@wk-usa.com

MODEL: SL-1680, 08/2014, 45340-14



AFTER SALES SUPPORT

📞 [1-888-367-7373](tel:1-888-367-7373)

📧 www.customer-service@wk-usa.com

MODEL: SL-1680, 08/14, 45340

5.6875"

8.25"